

EVVOSEMI[®]

THINK CHANGE DO



ESD



TVS



MOS



LDO

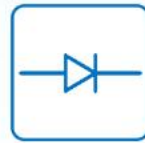

Diode

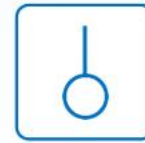

Sensor



DC-DC

Product Specification

▶ Domestic	Part Number	LGSOT05CLT1G
▶ Overseas	Part Number	LGSOT05CLT1G
▶ Equivalent	Part Number	LGSOT05CLT1G

EV is the abbreviation of name EVVO

The LGSOT05CLT1G is a dual monolithic voltage suppressor designed to protect components which are connected to data and transmission lines against ESD. It clamps the voltage just above the logic level supply for positive transients, and to a diode drop below ground for negative transients. It can also work as bidirectional suppressor by connecting only pin1 and 2.

FEATURES

- 2 Unidirectional Transil functions
- Low leakage current: $I_R \max < 20 \mu A$ at V_{RM}
- 300W peak pulse power(8/20 μs)
- Transient protection for data lines as per IEC61000-4-2(ESD) 15kV(air) 8kV(contact)
IEC61000-4-5(Lightning) see IPPM below
- We declare that the material of product compliant with RoHS requirements and Halogen Free.

APPLICATIONS

- Computers、Printers
- Communication systems

ABSOLUTE RATINGS(Ta = 25°C)

Parameter	Symbol	Limits	Unit
IEC 61000-4-2 (ESD)	Contact	± 8	kV
	Air	± 15	
Peak Pulse Power (tp = 8/20 μs)	PPP	300	W
	TJ	150	°C
Storage temperature	Tstg	-55 ~ +150	°C
Operating Temperature Range	TOP	-40 ~ +125	°C
(10 Second Duration)	TL	260	°C

ELECTRICAL CHARACTERISTICS (Ta= 25°C)

Device	V_{RWM} (V)	I_R (μA) @ V_{RWM}	V_{BR} (V) @ I_T (Note 1)	I_T	V_C (V) @ $I_{pp} = 1 A$	V_C (V) @ $I_{pp} = 5 A$	I_{PP} (A) @ $t_p=8/20\mu s$	C (pF)
	Max	Max	Min	mA	Max	Max	Max	Max
LGSOT05CLT1G	5	5	6	1	9.8	12.5	17	220

1. V_{BR} is measured with a pluse test current I_T at an ambient temperature of 25°C.

Electrical Parameter

Symbol	Parameter
V_{RM}	Stand-off voltage
V_{BR}	Breakdown voltage
V_{CL}	Clamping voltage
I_{RM}	Leakage current
I_{PPM}	Peak pulse current

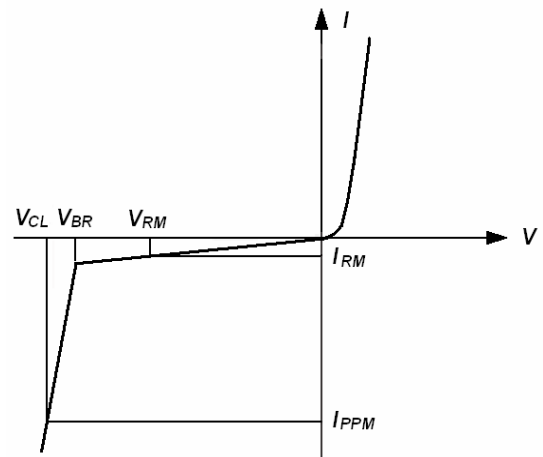

ELRCTIRCAL CHARACTERISTICS CURVES

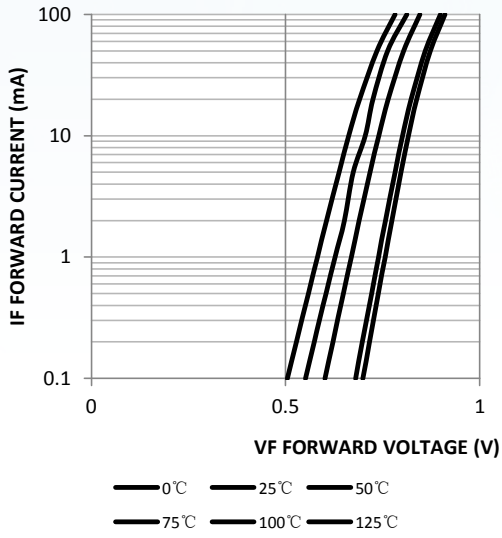

Fig 1. Forward character

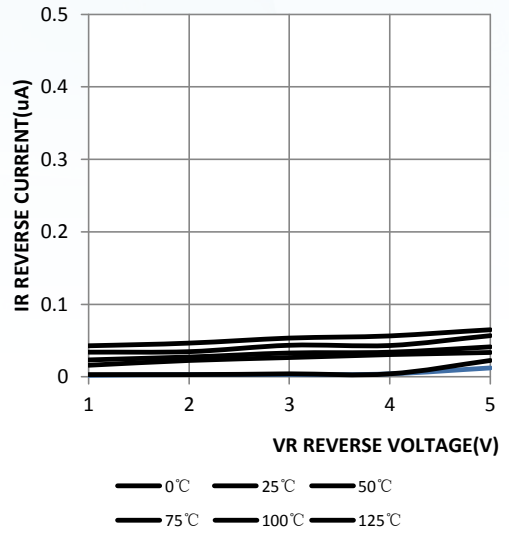

Fig 2. Reverse character

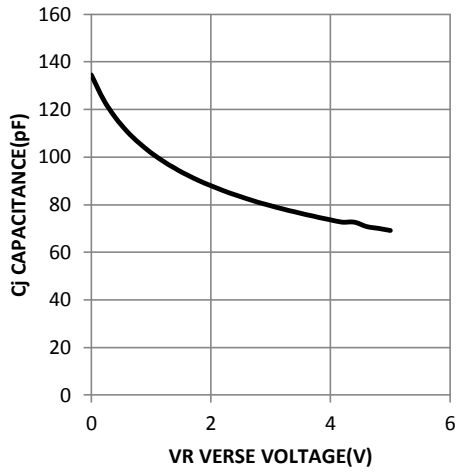
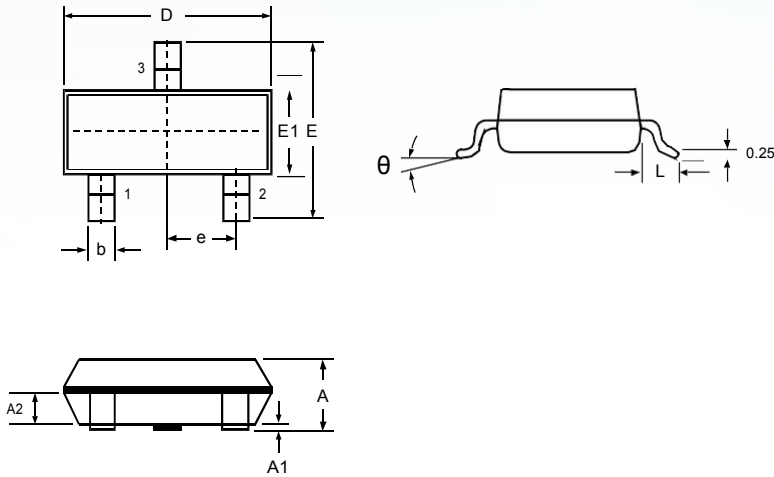

Fig 3. Capacitance character

Outline Drawing – SOT-23



SYMBOL	DIMENSIONS			
	MILLIMETER		INCHES	
	MIN	MAX	MIN	MAX
A	0.900	1.150	0.035	0.045
A1	0.000	0.100	0.000	0.004
A2	0.900	1.050	0.035	0.041
D	2.800	3.000	0.110	0.118
b	0.300	0.500	0.012	0.020
E	2.250	2.550	0.089	0.100
E1	1.200	1.400	0.047	0.055
e	0.950 BSC		0.037 BSC	
L	0.500	0.675	0.020	0.027
θ	0	8°	0	8°

Marking

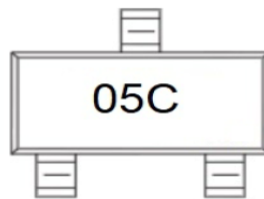

Ordering information

Order code	Package	Baseqty	Delivery mode
LGSOT05CLT1G	SOT-23	3000	Tape and reel

Disclaimer

EVVOSEMI ("EVVO") reserves the right to make corrections, enhancements, improvements, and other changes to its products and services at any time, and to discontinue any product or service without notice.

EVVO warrants the performance of its hardware products to the specifications applicable at the time of sale in accordance with its standard warranty. Testing and other quality control techniques are used as deemed necessary by EVVO to support this warranty. Except where mandated by government requirements, testing of all parameters of each product is not necessarily performed.

Customers should obtain and confirm the latest product information and specifications before final design, purchase, or use. EVVO makes no warranty, representation, or guarantee regarding the suitability of its products for any particular purpose, nor does EVVO assume any liability for application assistance or customer product design. EVVO does not warrant or accept any liability for products that are purchased or used for any unintended or unauthorized application.

EVVO products are not authorized for use as critical components in life support devices or systems without the express written approval of EVVOSEMI.

The EVVO logo and EVVOSEMI are trademarks of EVVOSEMI or its subsidiaries in relevant jurisdictions. EVVO reserves the right to make changes without further notice to any products herein.