

EVVOSEMI[®]

THINK CHANGE DO



ESD



TVS



MOS



LDO



Diode



Sensor



DC-DC

Product Specification

▶ Domestic	Part Number	EV2SD596-XXX-S1
▶ Overseas	Part Number	2SD596-XXX
▶ Equivalent	Part Number	2SD596-XXX

"S1" means SOT-23

EV is the abbreviation of name EVVO

■ NPN Transistors

■ Features

- High DC Current gain.
- Complimentary to 2SB624

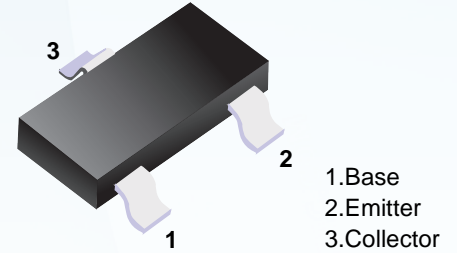

■ Simplified outline(SOT-23)

■ Absolute Maximum Ratings Ta = 25°C

Parameter	Symbol	Rating	Unit
Collector - Base Voltage	V _{CB0}	30	V
Collector - Emitter Voltage	V _{CEO}	25	
Emitter - Base Voltage	V _{EBO}	5	
Collector Current - Continuous	I _c	700	mA
Collector Power Dissipation	P _c	200	mW
Junction Temperature	T _J	150	°C
Storage Temperature Range	T _{stg}	-55 to 150	

■ Electrical Characteristics Ta = 25°C

Parameter	Symbol	Test Conditions	Min	Typ	Max	Unit
Collector- base breakdown voltage	V _{CB0}	I _c = 100 μA, I _E = 0	30			V
Collector- emitter breakdown voltage	V _{CEO}	I _c = 1 mA, I _B = 0	25			
Emitter - base breakdown voltage	V _{EBO}	I _E = 100 μA, I _c = 0	5			
Collector-base cut-off current	I _{CB0}	V _{CB} = 30 V, I _E = 0			100	nA
Emitter cut-off current	I _{EBO}	V _{EB} = 5V, I _c =0			100	
Collector-emitter saturation voltage (Note.1)	V _{CE(sat)}	I _c =700 mA, I _B =70mA			0.6	V
Base - emitter saturation voltage (Note.1)	V _{BE(sat)}	I _c =700 mA, I _B =70mA			1.2	
Base - emitter voltage (Note.1)	V _{BE}	V _{CE} = 6V, I _c = 10mA	0.6		0.7	
DC current gain (Note.1)	h _{FE(1)}	V _{CE} = 1V, I _c = 100mA	110		400	
	h _{FE(2)}	V _{CE} = 1V, I _c = 700mA	50			
Collector output capacitance	C _{ob}	V _{CB} = 6V, I _E = 10mA, f=10MHz		12		pF
Transition frequency	f _T	V _{CE} = 6V, I _c = 10mA	170			MHz

Note.1: Pulse test : Pulse width ≤350μs, Duty Cycle ≤2%.

■ Classification of h_{FE(1)}

Type	EV2SD596-DV1-S1	EV2SD596-DV2-S1	EV2SD596-DV3-S1	EV2SD596-DV4-S1	EV2SD596-DV5-S1
Range	110-180	135-220	170-270	200-320	250-400
Marking	DV1	DV2	DV3	DV4	DV5

■ SOT-23

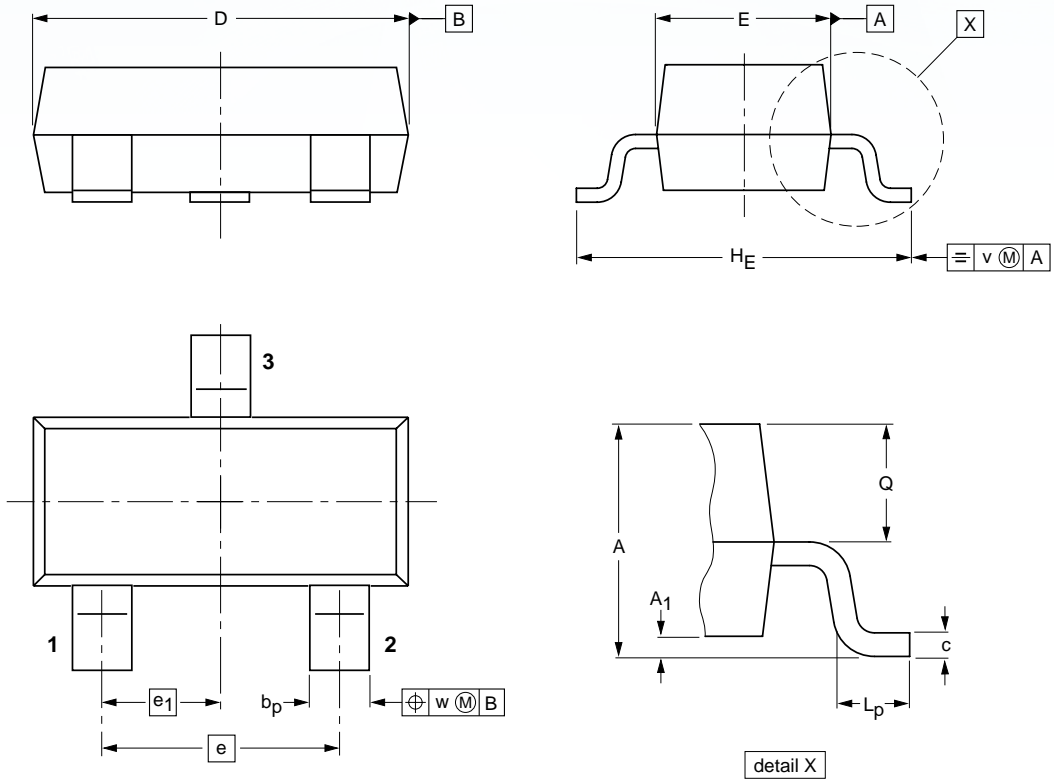

DIMENSIONS (mm are the original dimensions)

UNIT	A	A ₁ max.	b _p	c	D	E	e	e ₁	H _E	L _p	Q	v	w
mm	1.1 0.9	0.1	0.48 0.38	0.15 0.09	3.0 2.8	1.4 1.2	1.9	0.95	2.5 2.1	0.45 0.15	0.55 0.45	0.2	0.1

Disclaimer

EVVOSEMI ("EVVO") reserves the right to make corrections, enhancements, improvements, and other changes to its products and services at any time, and to discontinue any product or service without notice.

EVVO warrants the performance of its hardware products to the specifications applicable at the time of sale in accordance with its standard warranty. Testing and other quality control techniques are used as deemed necessary by EVVO to support this warranty. Except where mandated by government requirements, testing of all parameters of each product is not necessarily performed.

Customers should obtain and confirm the latest product information and specifications before final design, purchase, or use. EVVO makes no warranty, representation, or guarantee regarding the suitability of its products for any particular purpose, nor does EVVO assume any liability for application assistance or customer product design. EVVO does not warrant or accept any liability for products that are purchased or used for any unintended or unauthorized application.

EVVO products are not authorized for use as critical components in life support devices or systems without the express written approval of EVVOSEMI.

The EVVO logo and EVVOSEMI are trademarks of EVVOSEMI or its subsidiaries in relevant jurisdictions. EVVO reserves the right to make changes without further notice to any products herein.